

PARTS LIST				
ITEM	QTY	PART NUMBER (IMPERIAL)	PART NUMBER (METRIC)	DESCRIPTION
1	1	TSDS-652CUU	TSDS-652C-M6	65X65MM EXC BEARING, VACUUM COMPATIBLE, STAINLESS STEEL, XY-AXIS STAGE, CENTER MICROMETER, +/-6.5MM
2	1	TSDS-653LUU	TSDS-653L-M6	65X65MM EXC BEARING, VACUUM COMPATIBLE, STAINLESS STEEL, Z-AXIS STAGE, (VERTICAL PLATFORM/HORIZONTAL BASE) SIDE MICROMETER, +/-6.5MM
3	1	KSP-656FPUU	KSP-656FP-M6	65MM DIAMETER, BRASS, LAPPED-SURFACE BEARING ROTATION STAGE, 360 DEG MANUAL ROTATION, +/-5 DEG FINE ADJUSTMENT, HEX SCREW DRIVE

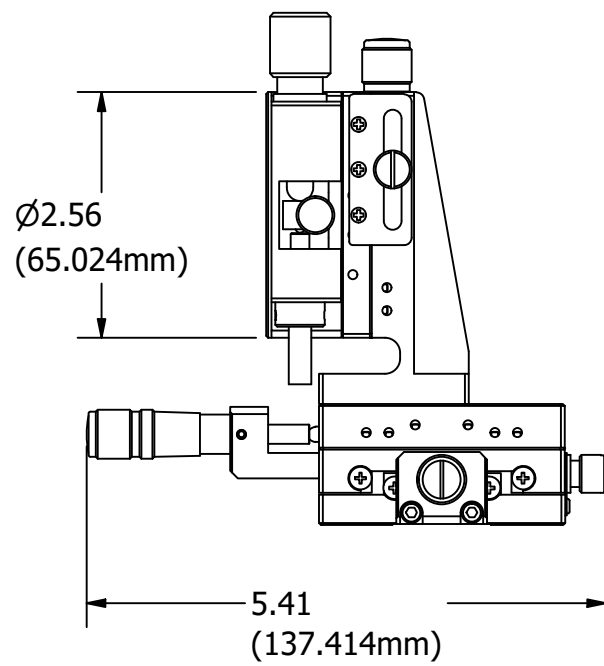
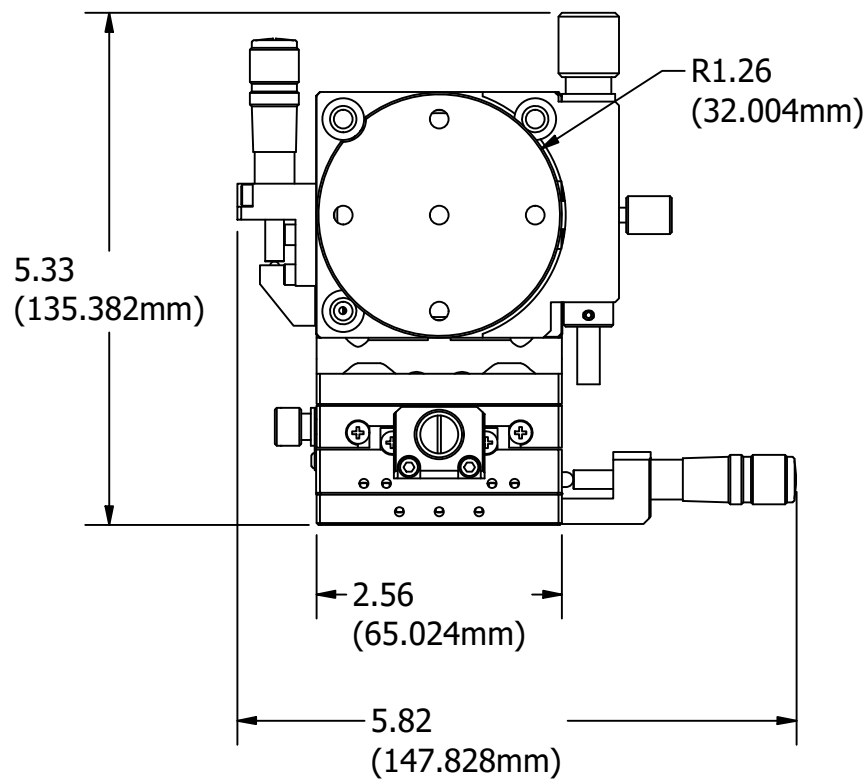
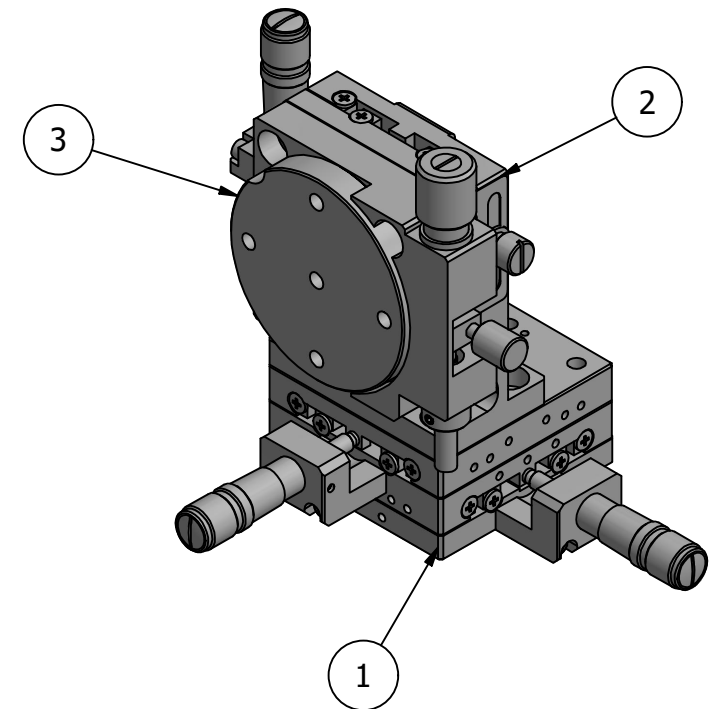
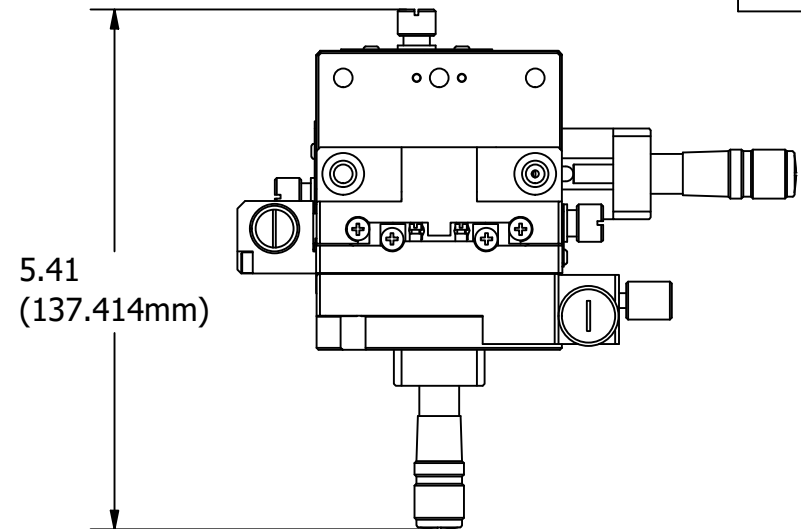

THIS DOCUMENT CONTAINS PROPRIETARY INFORMATION OWNED BY OPTOSIGMA CORP. AND MAY NOT BE USED, DUPLICATED OR DISCLOSED IN WHOLE OR IN PART FOR ANY PURPOSE INCLUDING DESIGN, MANUFACTURE OR PROCUREMENT WITHOUT THE WRITTEN PERMISSION OF OPTOSIGMA CORP.

 www.optosigma.com	TOLERANCES		DRAWN BY	DATE	MATERIAL	Contacts: USA: Sales@optosigma.com Europe: Sales@optosigma-europe.com	REV.
	FRACTIONAL ±.01" ANGULAR ±0.5°		BY sean	3/29/2023			
	0.X	±.03	CHECKED BY	DATE	FINISH	Assembly TSDS655LUU+KSP-656FPUU.idw TSDS655LUU+KSP-656FPUU	PAGE 1 of 1
	0.XX	±.01	APPROVED BY	DATE	SCALE		
0.XXX	±.005						
0.XXXX	±.0005						